EQUIPMENT LIST

PROFOTO GENERATORS & FLASH

Pro-8a 2400 Generator
Pro-7a 2400 Generator
Pro – B2 1200 Generator
Pro-B3 Air 1200 Generator
Acute B2 Air UV, Airsync
Acute B 600 Kit
Acute 2 1200 Generator
Acute/D4 Head 4800 WS (Inc. Standard Reflector)
Strip Light Medium 1.3m (Exc. Barn Doors)
Pro Ring 2
Pro Twin Head (Inc. Standard Reflector)
Pro Head UV 4800 WS (Inc. Standard Reflector)
Profoto Compact 300W (Monobloc)
Pro-B Mainsdock
Pro D1 1000 Air

HOT LIGHTS

Tungsten Arri 650W
Tungsten Arri 300W
Tungsten Arri 2K
HMI Arri 4K Par HMI FKF
HMI Arri 2.5K Par HMI FKF
Kino Flo 2 Bank 2'
Kino Flo 4 Bank 4'
Kino Flo 4 Bank 2'

PROFOTO SOFTBOXES

5 Ft Octa Bank
3 Ft Octa Bank
Softbox 1x6RF (30x180cm)
Softbox 3x4RF (90x120cm)
Softbox 2x3RF (60x90cm)
Softbox 2x2RF (60x60cm)
Softbox 1x4RF (30x120cm)
Softbox 4x6RF (120x180cm)
Softbox 2x3 Egg Crate Mesh

UMBRELLAS

Profoto 6' Giant Reflector
Profoto 7' Giant Reflector
Profoto 8' Giant Reflector
Profoto 10' Giant Reflector
Profoto Umbrella White 1.05m (Medium)
Profoto Umbrella Silver 1.05m
Profoto Umbrella White 1.30m (Large)
Umbrella Soft Silver (M & L)
White Diffusion Umbrella

REFLECTORS / LIGHTING ACCESSORIES

Profoto Zoom Spot (Searching Light)
Profoto Spot Small
Profoto Fresnel Spot Small
Profoto Hard Box
Profoto Softlight Reflector 26 (W / S Beauty Dish With Grid)
Softlight Reflector Diffuser (Sock)
Profoto Grid & Filter Holder Kit (Inc 5/10/20, Gel holder & filter)
Profoto Magnum Reflector 50°
Profoto Widezoom Reflector
Profoto Telezoom Reflector
ProGlobe
ProRing Softlight Reflector
25° Grid
10° Grid
Pro Lamp Ext.Cable 10m
Pro Lamp Ext.Cable 5m
Profoto Battery 12V W/ Cassette
Pro B Power Adaptor
Profoto Air Remote
Profoto Air Sync
Profoto Air USB
Pocket Wizard Plus II
Light Meter
Profoto Narrow Beam Travel Reflector
Profoto Snoot
Profoto Barn Doors
Sync Cables

GRIP – TRIPOD & STANDS

Manfrotto Super Boom
Double Wind Up Stand
Back Drop Support System (Light Kit Stands)
Super Boom
Standard High Stand
Standard High Roller Stand
Gitzo GT3540 XLS Tripod
Gitzo GH3780QR Ball Head
Gitzo 36X Systematic Tripod Centre Column
Extender
Gitzo GO65 Monitor Platform
Mini Boom
Manfrotto 680 Monopod
C-Stand With Grip Arm
Lighting 'Kit' Stand
Backlite Stand With Extension
Autopole
Minipole
Sandbags
Standard Boom

EQUIPMENT LIST

GRIP - SPIGOTS & ACCESSORIES

Super / Small A & A Clamps
Joining Stud
U-Hooks
Counterweight 5 Kg
Pins

SCRIMS / FLAGS / REFLECTORS

Butterfly Heavy 12x12 Frame & Support
Butterfly Heavy 6x6 Frame & Support
Westcott Scrim Jim Kit 4x6
Westcott Scrim Jim Silver/White Diffuser 4x6
Silk Stop 12x12
Black Stop 12x12
Silk Stop 6x6
Black Stop 6x6
Flags
Flexifil Silver/White (M)
Silver/Black Reflector (S & L)

DIGITAL

iMac 27' 3.06 Ghz 8GB Ram (Inc Photoshop / Capture One)
EIZO CE240W Monitor Display
Spider 3 Pro Calibrator
Wacom Intuous 4 Tablet & Pen
CF Card Reader (FW800)
10m USB Camera-Computer Data Cable
5m USB Camera-Computer Data Cable
WTE4A Wireless Transmitter
Lacie 320 GB Hard Drive

ON LOCATION

Magliner
Foldit Beach Cart
Wesco Mini Mover (Aluminum Folding Hand Truck)
Hoodman 13-17" Mac Laptop Hood
Large Generator/Light Carry Case
Medium Generator/Light Carry Case
Coffee Machine
Logitech iPhone/iPod Battery Powered Speakers
Desk
iMac 27' Tenba Air Case

POWER

Power Converter
Belkin Universal Charger
Profoto Pro Gas Units
Honda 6000W Generator (With A Tank Full Of Petrol)

CONSUMABLES

Black Velvet 25x10 Meters
Gaffa Tape
Gells (Price per meter)
Cinefoil (Price per half meter)
Colorama Paper (Price per meter – All Colours)
Colorama Paper Roll (Price per roll – All Colours)
Neutral Density Paper
One Stop Diffusion Paper

OTHER

Bowens Wind Machine
Standard Wind Machine
Fog Machine
Still Life Table
Extension Lead 30
Extension Lead 10
Apple Boxes (Pancake / Half Size)
Apple Boxes (Three Quarter Or Full Size)
Apple Boxes Set (1 Of Each: Pancake / Half / 3/4 / Full)
Polly Boards Black/White
Poly Board Feet
Plexi Board Black (Price per meter)

STYLIST'S PRODUCTS

Trestle Table / White 3x1.5m
Steam Iron
Iron & Ironing board
Heater
Clothe Racks



STUDIO RENTAL

Full Day (10 hours between 8:00am to 7:00pm)

Half Day (5 hours 8:00am-1:00pm or 2:00pm-7:00pm)

Overtime (Per hour rate outside the booked time)

Facilities:

- 2-Dock backlit make up room
- Steamer & ironing board for wardrobe
- Private bathroom with shower
- Wifi
- Air-conditioning
- iPod capable stereo system
- Fully equipped kitchen
- Client lounge area
- Coffee machine
- 20kw power supply
- Ground floor car access

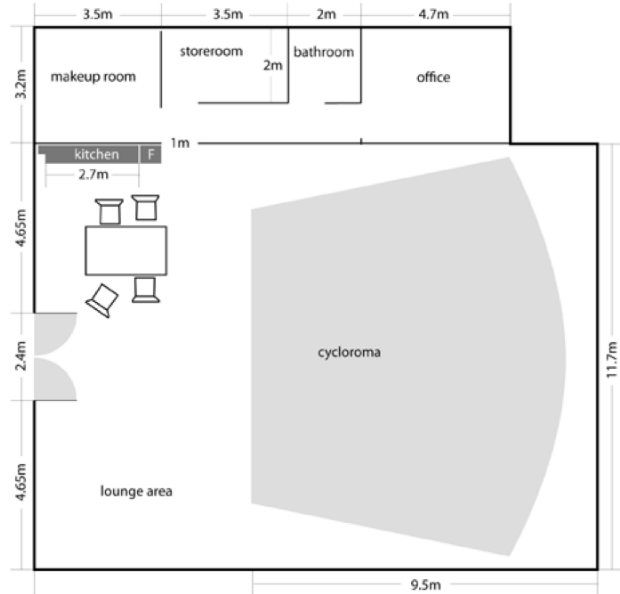

MAP TO STUDIO





TERMS AND CONDITIONS 条款

EQUIPMENT RENTAL 摄影器材租赁

Rental rates are based on a 24-hour period commencing at the time of collection if within business hours. Alternatively pickup or delivery can be arranged outside of business hours at an additional transportation charge. Flat rates are based on pickup and drop off at the BPS studio.

本条款中所涉及的费用均以天（二十四小时）计算，从器材交付（在营业时间内）时起算。若器材交付或运送超出营业时间，需收取额外的运输费用。基本租赁费用基于从影棚离开与到达的时间。

Rentals require a deposit of the full replacement value of every item hired or the payment of a 50% deposit plus the provision of a valid ID card or passport, to be returned after an inspection of all items used.

器材租赁需支付所租器材全额等值押金，或支付百分之五十的押金并提供有效的身份证或护照，证件将在检验所有使用器材均无损坏后归还。

All rental charges are due in full at the time of return. Any confirmed equipment hire that is not canceled within 24 hours of scheduled pick-up will be charged at a one-day rental fee.

所有租赁费用应在归还器材时全额支付。任何器材预订的取消请提前一天（二十四小时）与我们联系。当天取消无效，按一天租金收取费用。

Equipment is provided cleaned and in full working order, and must be returned in the same condition. Clients take full liability for all equipment from the point of collection or delivery, when they are invited to inspect all items supplied.

提供的器材确保清洁和正常运作，归还时亦应保持同等状态。客户接收器材时请仔细检查，一旦交送，由承租人全权负责。

Clients are expected to be appropriately trained and know the correct and safe operation of every item hired and will be held liable for any damage. Damage caused through negligence or a failure to know the correct operation of equipment will not be accepted as a reason to default on payment.

客户需在租赁前经过良好训练，清楚器材安全正确的使用方法，并对可能造成的损坏负责。如因操作不当而引起损坏，承租人不得以此作为拒绝付款的理由。

Should any damage to equipment occur BPS staff must be informed immediately. Clients will be liable to compensate BPS for earnings lost on any equipment made unavailable for use at the full day rental rate. The full costs of repair or replacement will be payable on return.

如器材发生故障需及时与我们联系。客户有义务赔付本公司维修时造成的租金损失，并在归还时支付所有维修及更换费用。

Should equipment fail or malfunction it is the responsibility of the client to inform BPS management immediately. Any faulty item will be replaced at no additional charge. Where it is found that equipment has failed due to negligence, abuse or improper use, any and all replacements will be charged at full day rates.

如器材发生故障，请客户及时与我们联系，我们将无偿更换器材。如因承租人疏忽、滥用或使用不当造成的故障，承租人必须支付更换器材的全天租金。

Any loss or theft of BPS equipment must be fully reimbursed at the full replacement cost at the time the rental is due, plus the agreed rental fee. Delayed payment on any item lost or stolen item will incur an additional charge of the full day rental rate until that item is paid for in full.

若发生器材丢失或被窃，则应在租赁到期时全额赔偿，外加租金。延期支付丢失或失窃器材的费用将收取额外的全日租金，直至付清。

It is the renter's responsibility to insure any equipment. All insurance claims are the responsibility of the renter - not BPS. 承租人承担对所租器材的保险。本公司不负任何器材的保险和索赔事宜。

TERMS AND CONDITIONS CONTINUED...条款

STUDIO RENTAL 影棚租赁

The BPS rental studio comprises a white cyclorama, client lounge area, makeup room plus fitted kitchen and bathroom. Air conditioning, an iPod stereo-system, wireless Internet and complimentary coffee is available throughout.

北京摄影空间影棚包括白色无影墙、休息区、化妆间、整体厨房和卫生间，同时提供 24 小时冷暖空调、无线网络、ipod 立体声系统及免费咖啡。

A full day studio hire provides for up to 10 hours occupancy, Monday to Saturday, 8am – 7pm. The half-day rate provides for up to 5 hours in the morning before 1pm, or up to five hours in the afternoon from 2pm.

影棚周一至周六可全天租赁，上午八点起至下午七点止，十小时以上视作超时；可在下午一点前或两点后用作半天租赁，五小时以上视作超时。

Overtime is charged at 500 RMB per hour while a booking on a Sunday or a public holiday will incur an extra fee of 500 RMB.

超时费用为每小时人民币 500 元。周日及公共假期租赁额外收取费用人民币 500 元。

A 50% deposit is required to confirm all studio bookings. Full payment must be made on the day of hire, including any equipment used. Cancellation of a confirmed booking must be made at least 48 hours in advance otherwise clients will be subject to a charge of 50% of contracted revenue.

所有出租预订要求提前支付 50% 押金，作为确认。客户需在租赁当天支付包括所有租赁器材在内的全额费用。取消预订时，客户须提前 48 个小时通知。否则，北京摄影空间有权收取相当于合同金额 50% 的费用。

Clients may not bring lighting and grip equipment onto the premises, unless under prior agreement.

除非有预先协议，客户不得在影棚内使用自己的灯光和器材。拍摄期间所有饮食需与影棚人员进行协调安排。

Clients are encouraged to check regarding rental items not listed by BPS as these are often possible to source via our extensive network of suppliers.

如器材单上没有所需器材，请另行确认，我们可以通过供应商为您提供。

The studio and all equipment must be returned by the lessee and not sub-leased or assigned to another party. The studio and all equipment hired will be maintained and serviced in a professional manner and returned undamaged and in full working order.

影棚和所租器材需承租人亲自按时归还，且不得转租或转交给其他任何一方。客户使用影棚及摄影器材时需注意专业操作，归还时确保没有任何损坏且能完全正常工作。

The BPS studio is rented in a clean condition with a white cyclorama and the lessee will undertake to return it clean and free of equipment or props and other waste. If the cyclo needs to be cleaned after a shoot 400 RMB will be charged. Any extra cleaning (beyond normal use) or repair costs will also be charged to clients.

北京摄影空间确保影棚和无影墙在出租时呈清洁状态，客户有义务在归还前清理现场，不得遗留任何器材、道具或杂物。如果拍摄结束后无影墙需进行清洁，客户应交纳相关费用人民币 400 元，以及任何额外的清洁（超过正常使用范围外）或维修成本。

TERMS AND CONDITIONS CONTINUED...条款

STUDIO RENTAL 影棚租赁 Continued...

Studio furniture may be used in a normal way or as a prop, on agreement with BPS staff. Users may not alter, modify, paint or cover furniture. Any damage to furniture or fittings will be the liability of the hirer. Damaged items may be charged at full replacement cost.

获得北京摄影空间员工同意后，客户可正常使用棚内家具或用作道具，但不得对家具做任何改动、修改、粉刷或覆盖。承租人需承担对家具和配置的任何损坏，并全额赔偿已损坏的项目。

All food orders must be coordinated through studio staff. BPS offers a full range of catering services or local food deliveries and provides a full range of plates and glasses for complimentary use.

拍摄期间所有饮食需与影棚人员进行协调安排。我们提供一系列的餐饮和外卖服务，并可免费提供杯盘等餐具。

BPS management has the right to change prices and rates without notice. Fees shall be confirmed prior to shooting.

本公司保留修改此价格单的一切权利，而无需另行通知。费用应在拍摄前协定。

TERMS AND CONDITIONS CONTINUED...条款

OTHER TERMS 其他条款

All equipment and studio rental charges and any production fees are due in full by the completion of a rental or project, unless otherwise arranged.

所有器材和影棚租金及相关制作费用（如无其他安排）应在租赁到期或项目完成时全额支付。

Transportation and BPS assistants may be booked in advance to assist clients working at the studio or on location. Translators are also available on request.

可提前向本公司预订运输及摄影助理，协助客户进行影棚或外景拍摄。亦可按需提供翻译服务。

The BPS studio and all equipment must be returned by the lessee and may not be sub-leased or assigned to any other party.

本公司影棚以及所有器材必须由承租人交还，不允许转租或转交给任何其他方。

BPS does not guarantee or assume responsibility for the performance or results of the equipment and studio, nor any accidents that occur during use.

对器材或场地未能达到预定效果，本公司不作出保证及承担责任。也不对使用器材或场地时发生的意外负责。

Studio and equipment rental rates do not include fapiao tax, which is charged separately at the bottom of the estimate.

影棚及器材报价均不包含税金，如需开具发票，须支付相当于全额租金百分之六的税金。

BPS will not be responsible for any loss or theft of personal property that belongs to any renter, client, assistant or other production crew. Clients are responsible for the insurance of their own equipment.

本公司不对属于任何承租人、客户、助理或制作人员的个人财产损失负责。客户需对其自带设备进行保险。

BPS shall not be responsible for any legal costs, damages, payments or fines due to breach of this agreement and shall be fully indemnified by the client for any such loss. Clients are responsible for the insurance of their own equipment.

本公司不承担因承租方违反此协议所产生的一切法律费用、损失和罚金等。客户需对其自带设备进行保险。

While in the studio, clients must abide by the laws of the People's Republic of China. Where any breach of the law takes place BPS reserves the right to immediately halt all work and fees shall still be payable in full, with no refunds given.

拍摄期间，客户必须遵守中华人民共和国相关法律。一旦发生违法情况，本公司有权立即中止拍摄，影棚租赁及其他相关费用将不会退回。

Force Majeure: BPS is not liable for any extraordinary external event beyond our control that may affect the performance or functionality of our studio or equipment, such as riot, crime, flooding, earthquake or interruption to local regional power supply.

BPS 不对任何人力不可抗力事故负责，包括地震，洪水，暴乱，犯罪，本地电源问题。

It is the lessee's responsibility to insure all equipment that is transported outside the immediate vicinity of Beijing. 承租人有责任为所有运送到北京以外地区的器材购买保险。

ALL ESTIMATES DO NOT INCLUDE FAPIAO TAX. INVOICE TAX MUST BE CARRIED BY THE LESSEE. ALL PRICES ARE SUBJECT TO CHANGE WITHOUT NOTICE. TERMS AND CONDITIONS APPLY.

所有报价均不包含税金。承租人承担发票税金。本公司保留修改此价格单的一切权利。各项条款适用。